

# FLOAT GASKET REPLACEMENT KIT

Please read complete instructions before replacing components.

## Parts Included

Part #	Qty	Description
100062	1	BOILER TANK FLOAT WASHER
100067	1	BOILER TANK FLOAT GASKET,NTEAR
100066	1	BOILER TANK FLOAT GASKET,SILIC
15001	1	WASHER,FLAT,SS,5/32X3/8"
100060	1	FLOAT,BRASS CONTACT
15003	2	WASHER,FLAT,S.S.,5/16"X11/16"
15501	2	HEX NUT, SS, 1/4" - 20

## Tools Required

Red Robertson Screwdriver  
#2 Phillips Screwdriver  
Adjustable (Crescent) Wrench  
7/16" Deep-Well Socket

## Assembly Instructions

1. Ensure that all of the parts listed above are included in your replacement kit.
2. Turn main power switch on distiller off and unplug cord from wall plug.
3. Drain the boiler tank. CAUTION: DRAIN VALVE MAY BE VERY HOT. Wait at least 1 hour for distiller to cool.
4. Remove the distiller covers. On a 26-CT, 26D-8, 26C-8 or 26-14, this will require disconnecting the feed line and removing the feed line fitting on the back of the distiller. ENSURE SADDLE VALVE IS CLOSED BEFORE DISCONNECTING FEED LINE.
5. Remove the nuts attaching the lexan switch plate to the copper studs. Remove the switch plate from the studs so that it hangs by it's wires.
6. Remove the nuts attaching the float washer to the boiler tank. Remove the brass contact and it's washer. Remove the large float washer and both gaskets, being careful not to bend the float rod.
7. Place the new silicon gasket over the studs. Place the gasket over the threads on the screw welded to the float rod, but do not stretch the gasket over the screw head. Ensure the gasket is flush against the boiler wall. Do the same with the no-tear gasket.
8. Attach the large float washer to the studs. Attach the brass contact with it's washer to the float rod.
9. Attach the lexan switch plate to the studs, ensuring that the wires do not interfere with the float rod or any other components.
10. Reattach covers. Ensure impurities drain valve is closed. Reattach water feed line if it was removed and open saddle valve.

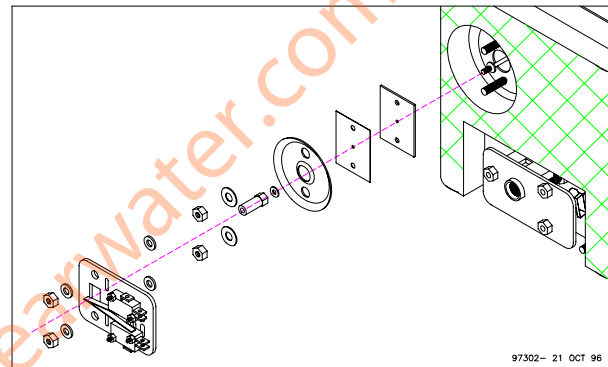

The distiller should now operate properly. If it does not, we suggest you take your distiller to an authorized service representative.